

# Magnetic Float Type Level Switch

## SERIES: LSF200

- EASY INSTALLATION
- SELECTABLE FLOAT CHAMBER

### DESCRIPTION

Indumart Series LSF200 Magnetic Float Type Level Switches can be used on the sidewall of tanks for level control applications. The operating principle of the LSF200 Series is, when the rising liquid level tilts the float upward, the magnet attached to the end of the body actuates the micro switch.

The LSF200 Series is mostly used in hot and cold water systems, hydraulic equipments, lubricating oil tanks and coolant tanks.

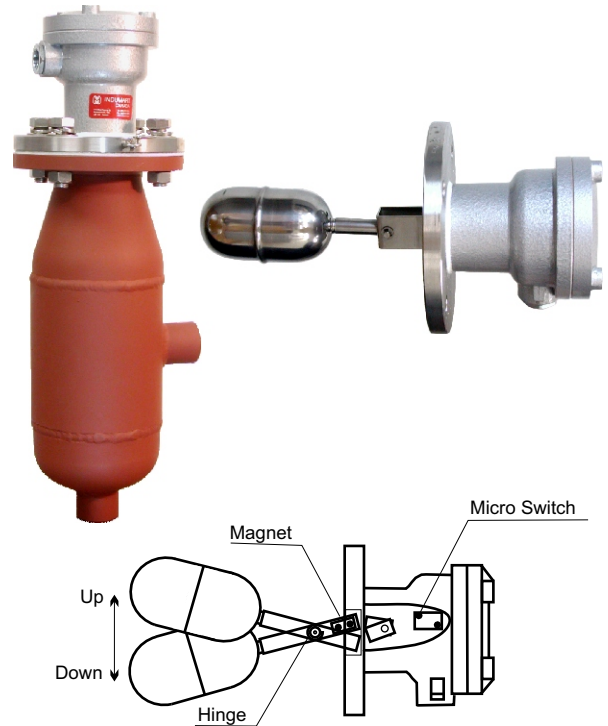

### WHAT TO AVOID

- Avoid dropping pounding or striking the level switch (fig. 1).
- Do not install the switches near a drain outlet or a feedwater inlet to avoid malfunction due to chattering (fig. 2).
- Installation near a strong magnetic field should be avoided (fig. 3).
- The level switch should not be used for liquids containing iron particles or other strongly magnetic materials. The instrument must be cleaned frequently, if used in high viscosity liquids or those containing floating materials (fig. 4).

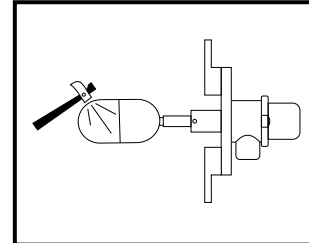

(fig.1)

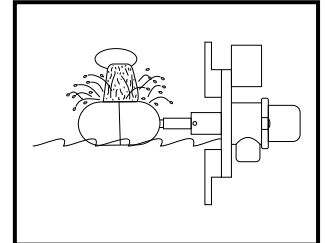

(fig.2)

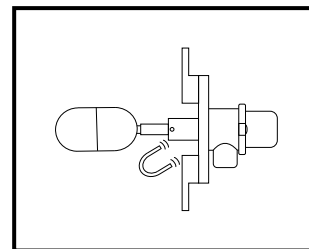

(fig.3)

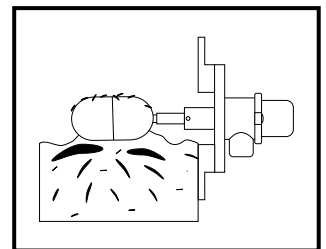

(fig.4)

### DIMENSIONS (mm)

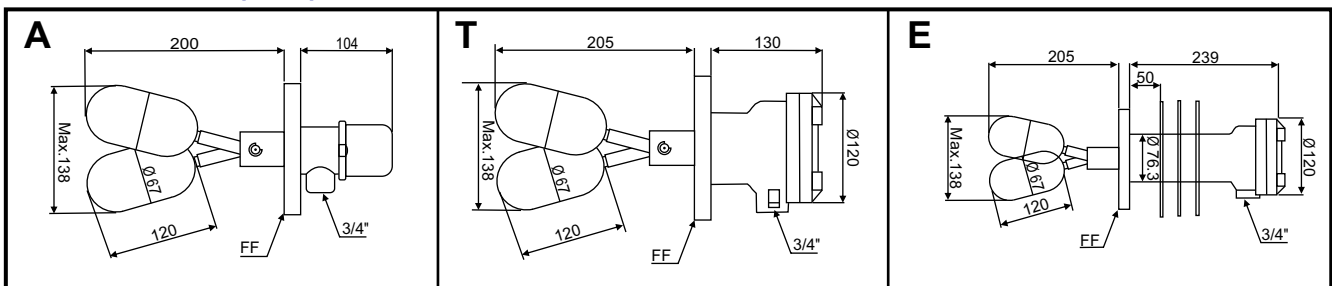

## SPECIFICATIONS

Type		LSF200 - A (Std)	LSF200 - E	LSF200 - T
Contact Rating		250VAC,10A		
Switch		Micro Switch		
Operating Temperature	Sensing Part	-25...+120°C		-25...+210°C
	Housing Part	-25...+210°C		
Operating Pressure		150 psi (10 bar) Max.		
Output		1 SPDT		
Specific Gravity		Greater than 0.7		
Actuation Angle		±15°		
Mounting Standard		150 # , 2.5 " FF		
Material	Sensing Part	SS304/SS316		
	Housing Part	ADC12	AC2B	
Enclosure Class		Weather proof	Explosion proof (Exd IIB T3)	Weather proof

## CHAMBER SELECTION

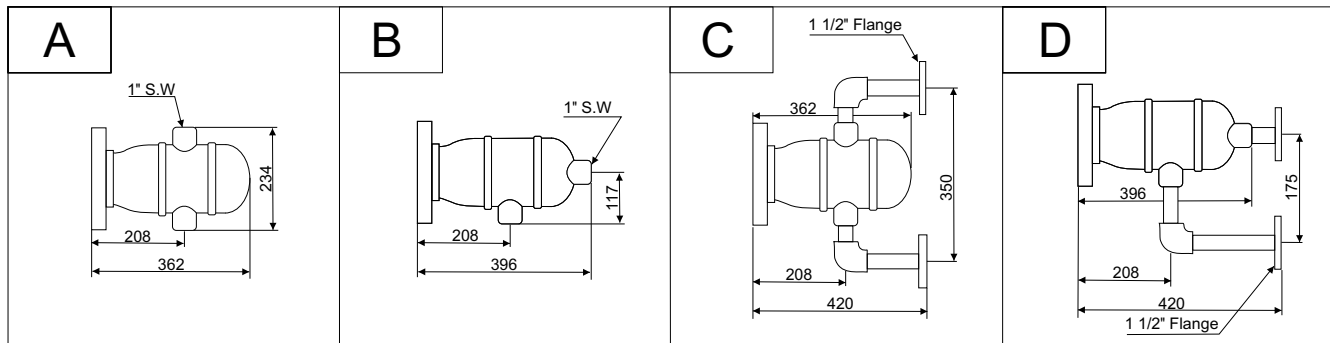

ORDER CODES	CHAMBER SELECTION
<p><b>MODEL:</b> LSF200 - <input type="checkbox"/> <input type="checkbox"/> <input type="checkbox"/> <input type="checkbox"/> <input type="checkbox"/></p> <p><b>VERSION</b>                      Standard                      Explosion proof                      High Temperature</p> <p><b>WETTED PARTS MATERIAL</b>                      SS304 (Std.)                      SS316                      Other</p> <p><b>MOUNTING</b>                      FF Flange                      Other</p> <p><b>MEASURING PART LENGTH</b>                      200 mm (Std.)                      201...300 mm                      301...400 mm</p> <p><b>CONDUIT CONNECTION</b>                      1/2"                      3/4"</p>	<p><b>LSF200-CH-</b> <input type="checkbox"/> - <input type="checkbox"/> <input type="checkbox"/></p> <p><b>TYPE OF CHAMBER</b>                      Top Bottom (S. Weld Type)                      Side Bottom (S. Weld Type)                      Side Side (Flange Type)                      Side Side (Flange Type)                      Other</p> <p><b>CHAMBER PARTS MATERIAL</b>                      Carbon Steel                      SS304                      SS316                      Other</p> <p><b>CHAMBER PRESSURE RATING</b>                      Specify the Max. Pressure or SCH. #</p>



**INDUMART INC.**

1-15 W. Pearce St., Richmond Hill, Ont. L4B 1H6, Canada  
 Phone: (905) 707-9998 Fax: (905) 707-8484 E-mail: Sales@Indumart.com